

3/27/2019 1:04:28 PM



1 SECOND FLOOR ACCENT FINISH PLAN  
3/32" = 1'-0"

GENERAL NOTES

- A. ACCENT FINISH PLAN INDICATES PATTERNED AREAS ONLY, REFER TO FINISH SCHEDULE FOR A COMPLETE LIST OF FINISHES.
- B. ACCENT PAINT LOCATIONS ARE INDICATED AS A-P AND EXTENTS ARE SHOWN BY DASHED LINES.
- C. ACOUSTICAL WALL PANEL LOCATIONS ARE INDICATED AS AWP AND EXTENTS ARE SHOWN BY DASHED LINES.

FLOOR PATTERN KEYNOTES

REPRESENTED BY [n]

APPLIES TO DRAWINGS A3.0.1 - A3.0.n

- 1 ACCENT PAINT ON WALL AT LANDING

**MOSELEYARCHITECTS**

911 N. WEST STREET, SUITE 205 RALEIGH, NORTH CAROLINA 27603  
PHONE (919) 845-0691  
MOSELEYARCHITECTS.COM

PROGRESS  
PRINT NOT FOR  
CONSTRUCTION

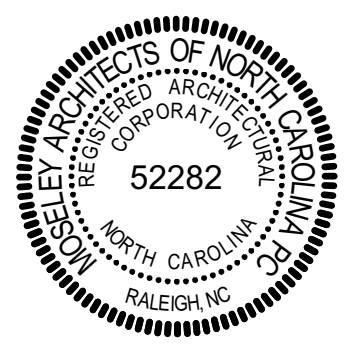

**Dobo Hall Renovation - Package A**

SCO PROJECT NO. 18-19798-01A  
UNC Wilmington  
4978 CAHILL DR, WILMINGTON, NC 28403

|             |                |
|-------------|----------------|
| PROJECT NO. | DATE           |
| 580999      | MARCH 27, 2019 |
| REVISIONS   |                |
| DATE        | DESCRIPTION    |
|             |                |
|             |                |
|             |                |
|             |                |
|             |                |

SECOND FLOOR  
ACCENT FINISH  
PLANS

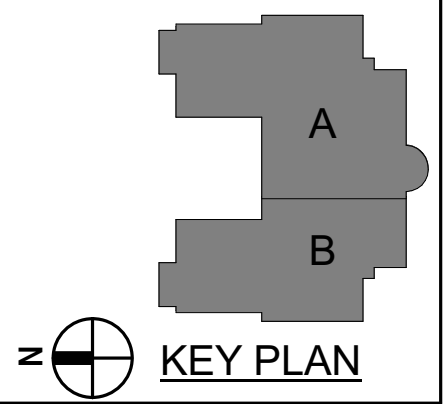

A3.0.3